



INDUSTRIAL SPACE FOR SUBLEASE - 17,013 SF



PROPERTY FEATURES

- +/- 17,013 SF Total SF Available (South Side)
- +/- 2,557 SF Offices (Second Floor)
- Private Offices / Kitchenette / Bathrooms
- Warehouse Office & Bathrooms
- 3 Double Wide Doors (5 Docks + 1 Concrete Ramp)
- Free Standing Building
- 24' Clear Ceiling Height
- 3-Phase Power
- Ample Parking - 1.82 AC Fenced / Shared Lot
- Heavy Manufacturing Zoning
- Move in Jan 2024 - 4 Years Term

For More Information Contact:

Elias G. Patsalos, CCIM
Phone: 305-804-9154
Email: elias@agorare.com

LEASE RATE

22 PSF GROSS

Agora Real Estate Group

7500 NW 25th Street, Suite 237, Doral, FL-33122

P: +1 (305) 804-9154 | F: +1 (866) 708-2763 | E: info@agorare.com

No warranty or representation, expressed or implied, is made as to the accuracy of the information contained herein, and same is submitted subject to errors and omissions.



FLOOR PLAN

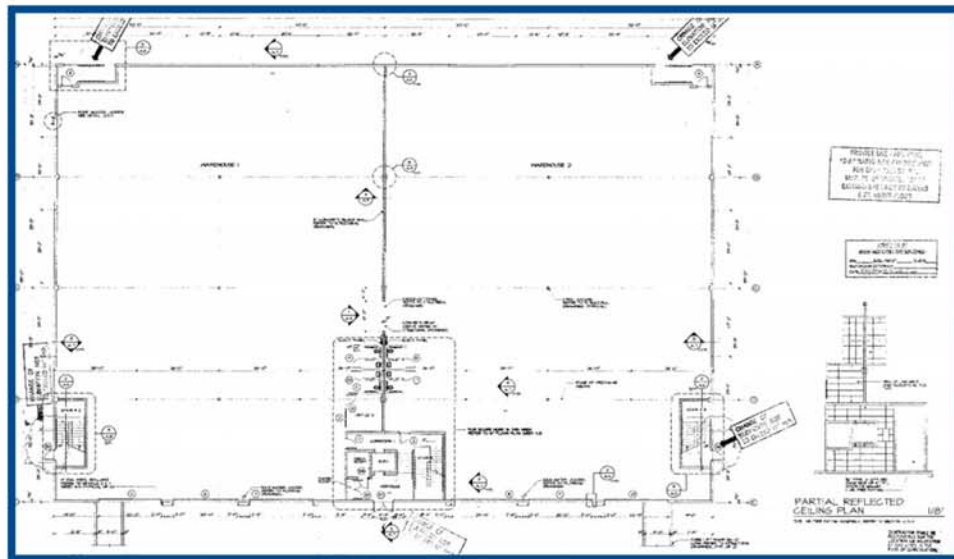

Agora Real Estate Group

7500 NW 25th Street, Suite 237, Doral, FL-33122

P: +1 (305) 804-9154 | F: +1 (866) 708-2763 | E: info@agorare.com

No warranty or representation, expressed or implied, is made as to the accuracy of the information contained herein, and same is submitted subject to errors and omissions.